

Category: Recommended

Benefits to Customers:

- Reduces Coolant waste and improves containment
- Eliminates leakage hazards

Summary: CarnaudMetalbox Engineering Ltd are recommending a Coolant Drip Tray Assembly for the 5000 Series Bodymaker which attaches to the Sump Door using round head fasteners. The Coolant Drip Tray collects coolant from the inside of the discharge guard door and recycles it back into the Bodymaker Sump, avoiding the potential loss of coolant and preventing hazards associated with leakage (e.g. slippery floors and working platforms). The Assembly can be retrofitted on site by plant personnel or CarnaudMetalbox Engineering Service personnel. The conversion kit (BOM no. 90430) includes silicone sealant and all drill bits and fasteners to facilitate installation.

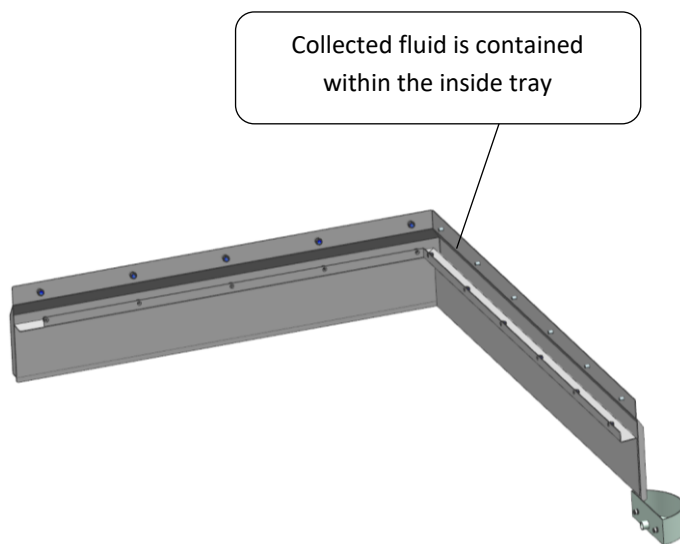

Figure 1

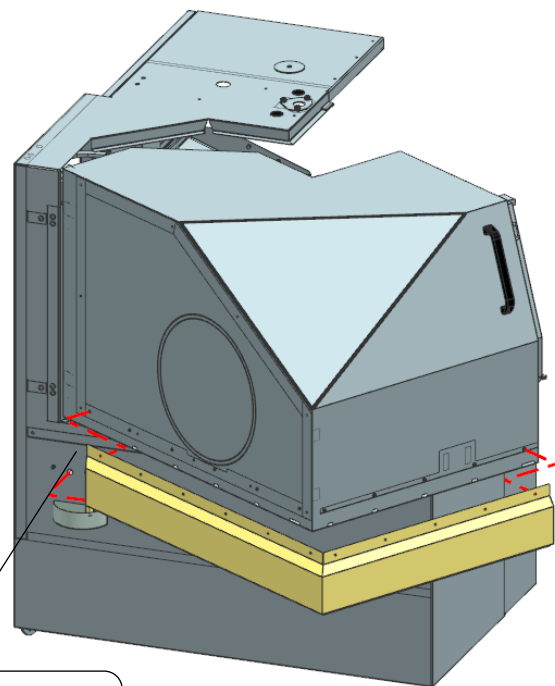

Figure 2

For further information regarding this Technical Bulletin, please contact either of the contacts below quoting Technical Bulletin number **TB5000-085** and your machine Serial Number. A complete library of Technical Bulletins is available on the company web site.

www.carnaudmetalboxengineering.co.uk